

SKY DECKS

Relaxed Family Dining



park place



The upper sky decks will offer a great view of the city skyline, the mountainside, the parks and the lumberyard, including the main stage

park  place



The structure itself, with sail canopies, flags and rope lighting will serve as a landmark, visible from the interstate and the surrounding area.



The lower deck, at train height 5 ft. will have access to the dining car through a door cut into the side of the dining car. The handicap ramp between the car and the saloon courtyard also provides kitchen delivery access. In current plans additional restrooms will be in the southeast corner along the entrance hall; stairwells in the southwest corner; with the northwestern portion providing additional all weather seating for the restaurant.

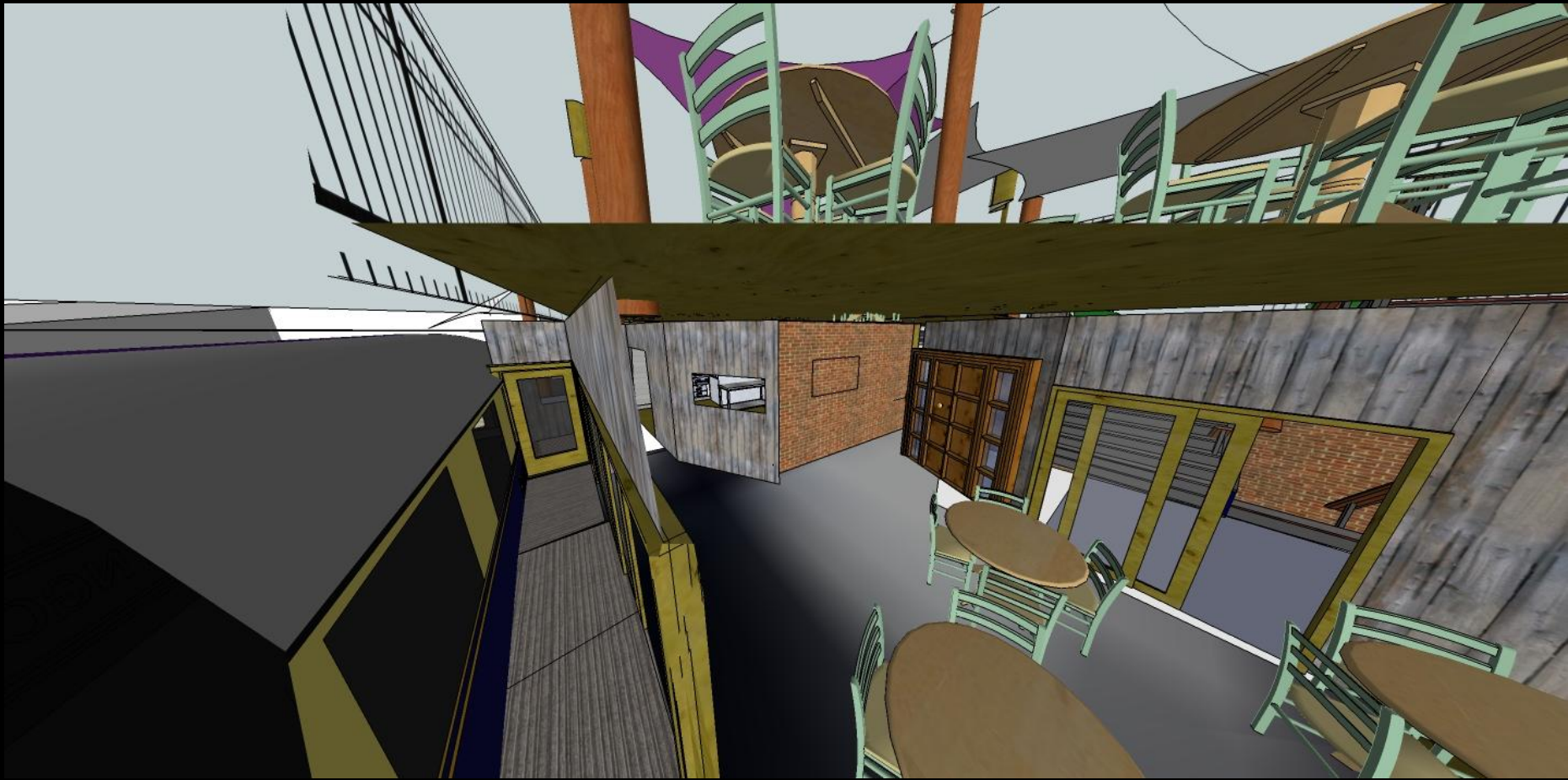

In the cut-away above the train on the left sits under the overhang of the upper deck. The exterior handicap access ramp leads to a hall between the dining car and kitchen/SkyDeck. The kitchen service window, in the center, opens to the enclosed, year-round bar/dining area with doors leading to the steps accessing the upper deck or ground level. The upper deck is 1500 sq. ft. allowing almost 175 patrons at full restaurant capacity.



In cut-away illustrates the kitchen being designed by prospective tenant using 45% of the lower deck; . The main entrance hall is through the door on the right providing delivery access.



After a hard days work downtown or just relaxing with the family, we expect the sunset view from the Park Place Plaza SkyDeck to be in high demand.